

Dimensional Data	
Product	Columbus McKinnon Super Strong Galvanized Safety Pin Anchor Shackle

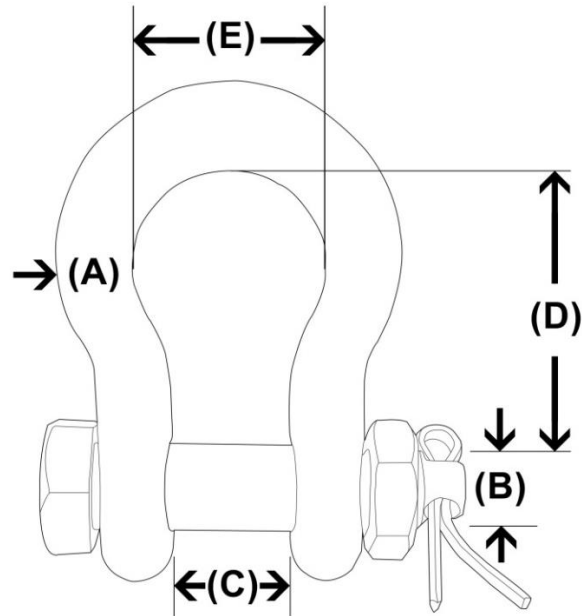

Dimensions are for Reference Only						
Item Number	Size (A)	Pin Diameter (B)	Opening Width (C)	Inside Length (D)	Inside Width (E)	Working Load Limit
M850G	1/2"	5/8"	27/32"	1-15/16"	1-3/8"	6,000 lb
M851G	5/8"	3/4"	1-1/16"	2-13/32"	1-5/8"	9,000 lb
M852G	3/4"	7/8"	1-9/32"	2-27/32"	1-29/32"	13,000 lb
M853G	7/8"	1"	1-7/16"	3-5/16"	2-1/16"	17,000 lb
M854G	1"	1-1/8"	1-23/32"	3-3/4"	2-17/32"	20,000 lb
M855G	1-1/8"	1-1/4"	1-27/32"	4"	2-11/16"	24,000 lb
M856G	1-1/4"	1-3/8"	2"	4-5/8"	2-7/8"	28,000 lb
M857G	1-1/2"	1-5/8"	2-13/32"	5-5/8"	3-1/2"	40,000 lb
MC860G	2-1/2"	2-3/4"	4-5/32"	10-1/2"	6-3/4"	110,000 lb